



Taman
Impian
Putra

Jalan Shell PD

Show Unit

DOUBLE-STOREY LINK

(22' X 80')

GRACE

(Only 36 units available)
Interior design options available.





FLOOR PLAN

BUILT UP AREA = 1,785.00 p.s.f
LAND AREA = 1,754.53 p.s.f

Ground Floor

First Floor

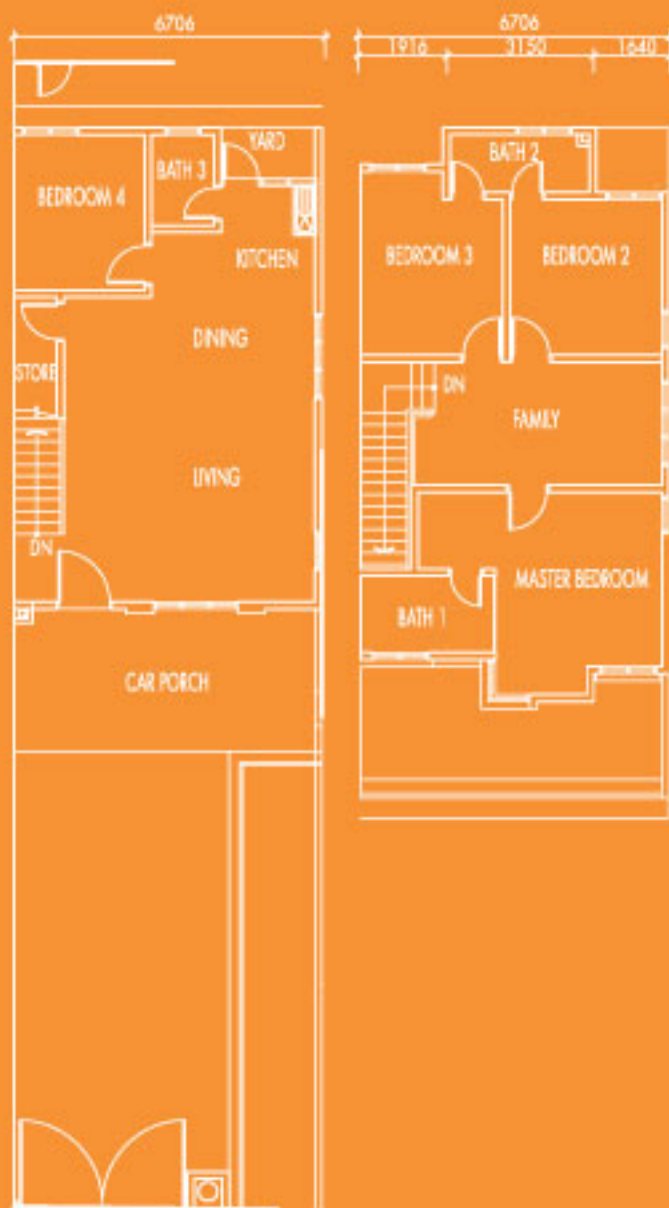

SPECIFICATION

STRUCTURE	Generally reinforced concrete frame
BRICK	Generally brickwalls
ROOFING TILES	Concrete roof tiles
ROOF	Timber roof trusses / R.C Slab
CEILING	Skim coating Gypsum board Asbestos ceiling board
WINDOWS	Aluminium framed casement window
DOORS	Timber door, Plywood flush door
LOCKS	Locksets
FLOORING	
Living & Dining	: Ceramic tiles
Kitchen	: Ceramic tiles
Bedroom 4	: Cement render
Bedroom (master, bed 2 & 3)	: Ceramic tiles
Family & Staircase	: Ceramic tiles
Bathrooms	: Ceramic tiles
Others	: Cement render
WALL TILES	
External	: Generally cement plaster with paint
Internal	: Generally cement plaster with emulsion paint
Kitchen	: 1500mm high ceramic wall tiles
Bathrooms	: 1500mm high ceramic wall tiles
SANITARY INSTALLATION	
Kitchen	: Aluminium sink
Bathrooms	: Wash basin, WC, shower rose, soap holder & paper holder
ELECTRICAL INSTALLATION	Intermediate Corner
Lighting point	14 15
Ceiling fan point	2 2
13A SSO	10 10
TV point	1 1
FENCING	1500 high chain link fencing
INTERNAL TELEPHONE TRUNKING AND CABLING	
Telephone point	: 1
MISCELLANEOUS	Refuse chamber & letter box

Another successful venture by:



PURCON (M) SDN BHD [146591-F]

Wisma PURCON B1-03-13, Jalan SR 1/9, Taman Serdang Raya, Section 9, 43300 Seri Kembangan, Selangor Darul Ehsan. Fax: 03-8941 2460/61

For more information, please call: **017-620 7875 012-698 8225 013-602 1388 03-8948 2922**

WWW.PURCON.COM.MY