

specifications

| | |
|-------------------------|---|
| STRUCTURE | Generally reinforced concrete frame |
| WALL | Generally brickwall |
| CEILING | Generally skim coat to the underside of floor slab Top most floors – asbestos-free ceiling – skim coat to the underside of floor slab |
| WINDOWS | Generally aluminium framed windows |
| DOORS | Entrance door – glass panel and door Plywood flush door Roller shutter Toilet – timber or pvc flush door |
| LOCKS | Lockset |
| WALL FINISHES | Generally acrylic based paint to external wall Emulsion paint to internal wall Toilet – wall tiles to 1500mm high |
| FLOORING | Generally cement render Floor tile to reception area Toilet – floor tiles |
| SANITARY INSTALLATION | |
| Water closet | 2 nos |
| Wash hand basin | 2 nos |
| Sink | 2 nos |
| ELECTRICAL INSTALLATION | |
| Lighting point | 20 nos |
| Power point | 13 nos |

The information contained in this brochure is subject to change and cannot form part of an offer or contract. All renderings are artist's impressions only and all measurements are approximate. While every reasonable care has been taken in preparing this brochure, the developer cannot be held responsible for any inaccuracies.

2 Storey Semi-Detached Showroom cum Warehouse 2層半獨立陳列室兼倉庫



TYPE
SUPERB

市中心的商業中心

具備互聯網及閉路電視

Another signature development of



Developer: Purcon Resources Sdn Bhd (387153-X)

Sales Enquiries: 089-888 911/886 911/882 911/880 911
012-2950 083/019-8835 969/012-3576 715/017-3978 667

Sales Office: MD1D 0763, Ground Floor, Block C, Ming Huat Light Industries, Dam Road, 91100 Lahad Datu, Sabah. Fax: 089-886 921

Headquarters: Wisma Purcon B1-03-13, Jalan SR 1/9, Taman Serdang Jaya, Section 9, 43300 Seri Kembangan, Selangor Darul Ehsan.
Fax: 03-8941 2460/61

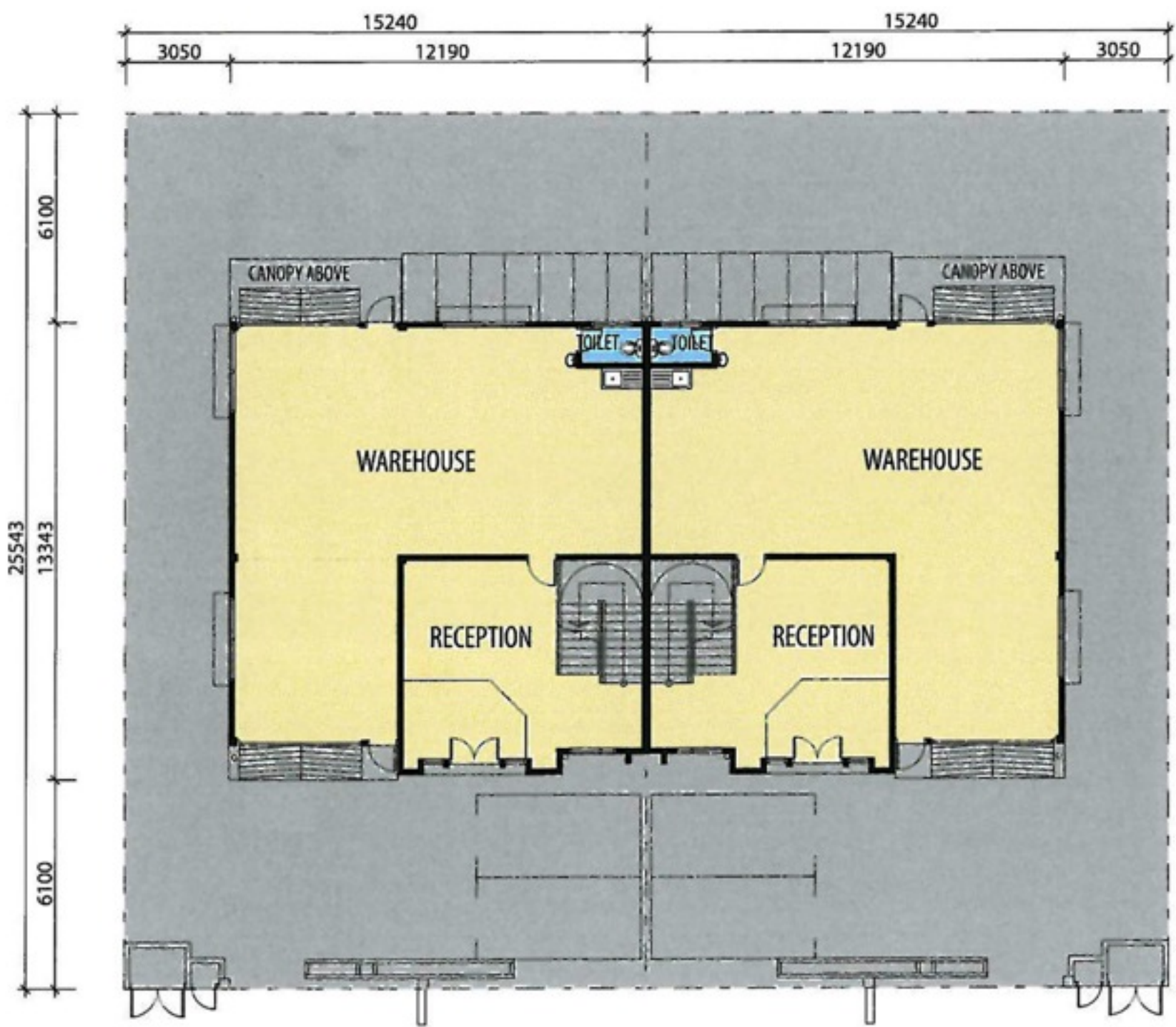

ground floor plan

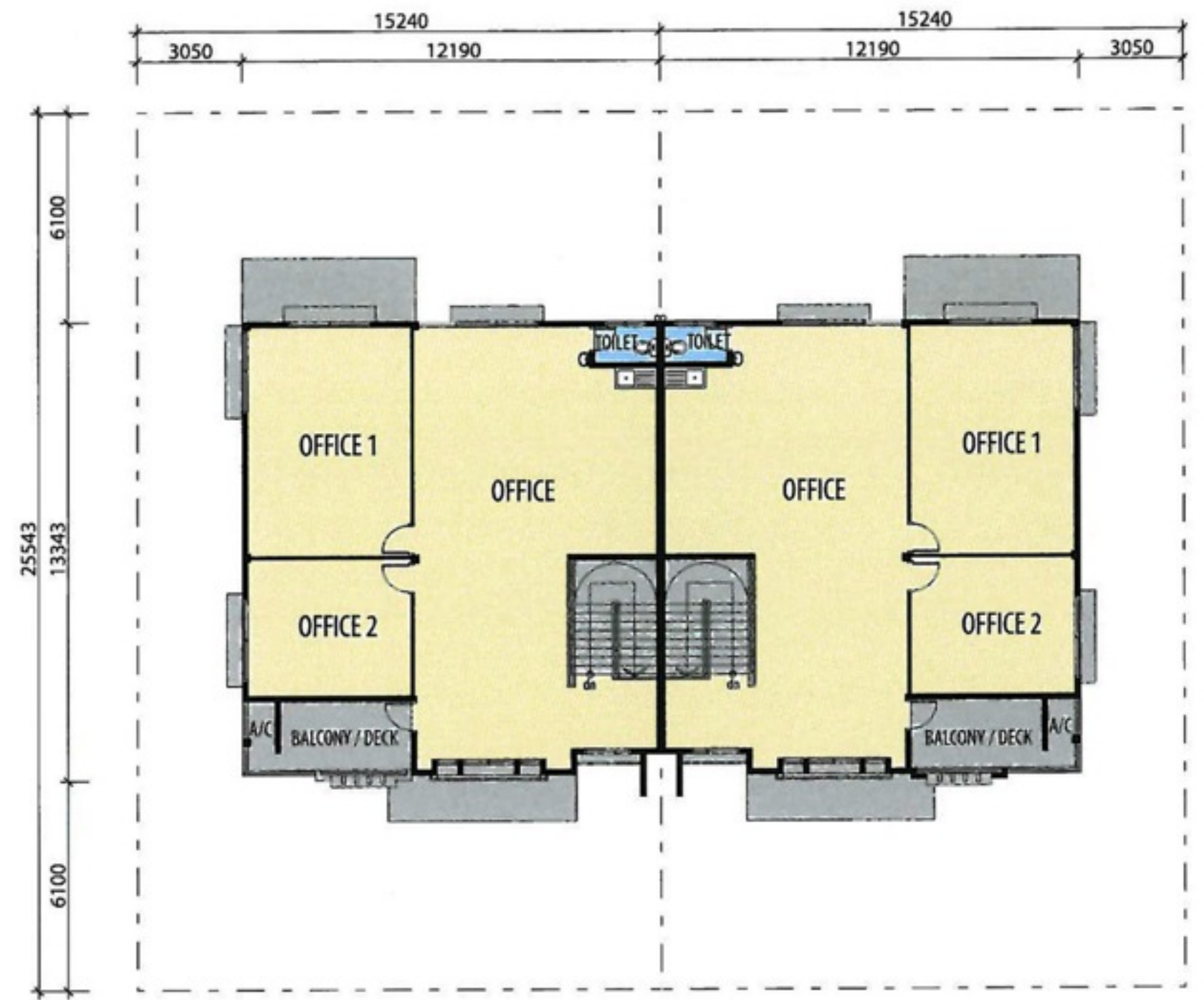

first floor plan

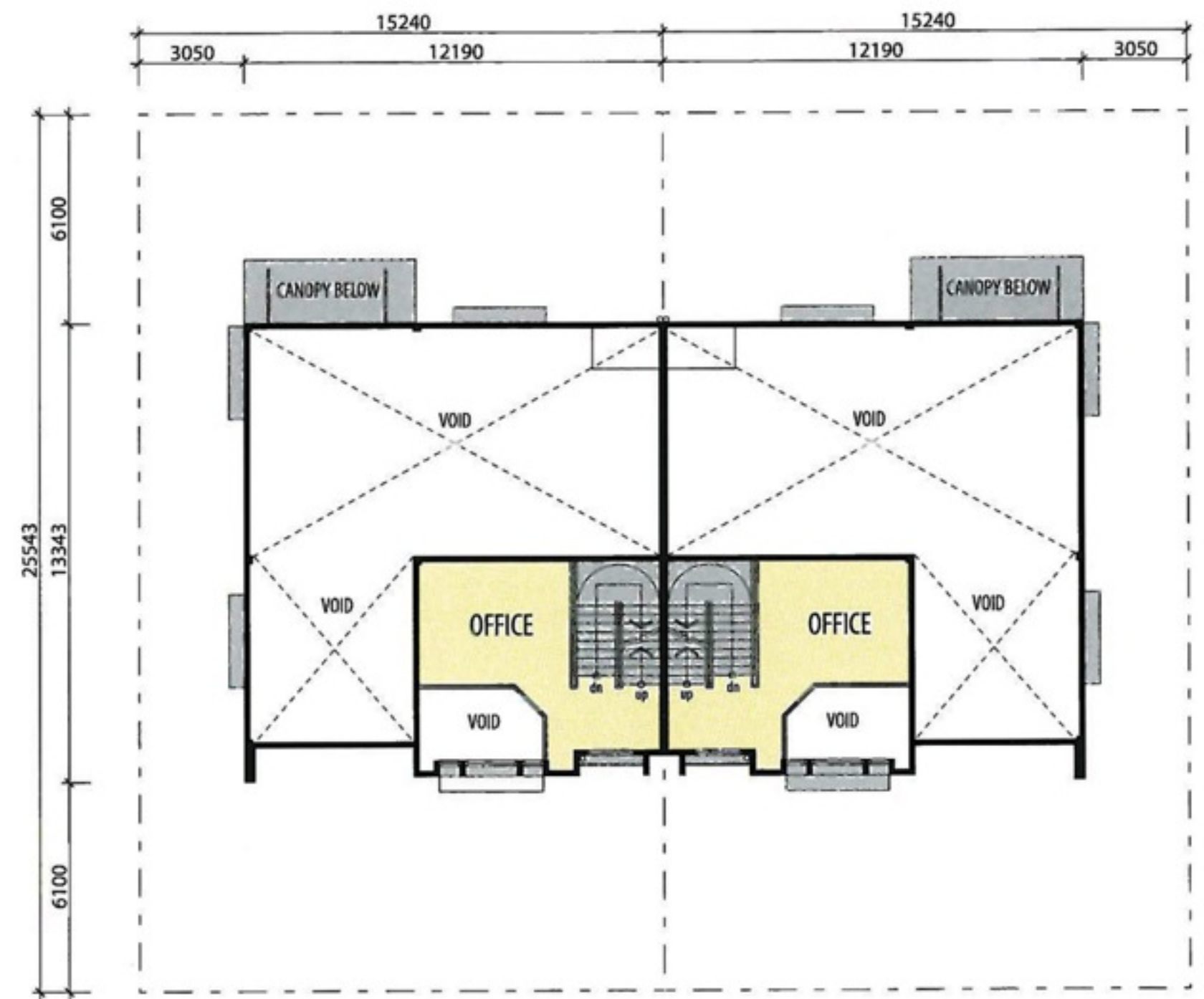

mezzanine floor plan